

## Warranty and Service Information

Rev. K

You may need only simple instructions to correct a problem with your product. Call the Consumer Assistance Hotline at 1-800-255-3700 rather than going to your retailer. Hours of operation are 6 a.m. to 9 p.m., Pacific Time, Monday - Saturday, and 6 a.m. to 7 p.m., Pacific Time, on Sundays (times subject to change). If the problem cannot be solved over the telephone, you will be offered express factory service through Nintendo or referred to the nearest NINTENDO AUTHORIZED REPAIR CENTER<sup>SM</sup>. Please do not send any products to Nintendo without calling us first.

### HARDWARE WARRANTY

Nintendo of America Inc. ("Nintendo") warrants to the original purchaser that the hardware product shall be free from defects in material and workmanship for twelve (12) months from the date of purchase. If a defect covered by this warranty occurs during this warranty period, Nintendo or a NINTENDO AUTHORIZED REPAIR CENTER will repair the defective hardware product or component, free of charge. The original purchaser is entitled to this warranty only if the date of purchase is registered at point of sale or the consumer can demonstrate, to Nintendo's satisfaction, that the product was purchased within the last 12 months.

### GAME PAK & ACCESSORY WARRANTY

Nintendo warrants to the original purchaser that the product (Game Paks and accessories) shall be free from defects in material and workmanship for a period of three (3) months from the date of purchase. If a defect covered by this warranty occurs during this three (3) month warranty period, Nintendo or a NINTENDO AUTHORIZED REPAIR CENTER will repair the defective product, free of charge.

### SERVICE AFTER EXPIRATION OF WARRANTY

Please call the Consumer Assistance Hotline at 1-800-255-3700 for troubleshooting assistance and/or referral to the nearest NINTENDO AUTHORIZED REPAIR CENTER. In some instances, it may be necessary for you to ship the complete product, FREIGHT PREPAID AND INSURED FOR LOSS OR DAMAGE, to the nearest service location. Please do not send any products to Nintendo without calling us first.

### WARRANTY LIMITATIONS

THIS WARRANTY SHALL NOT APPLY IF THIS PRODUCT: (a) IS USED WITH PRODUCTS NOT SOLD OR LICENSED BY NINTENDO (INCLUDING, BUT NOT LIMITED TO, NON-LICENSED GAME ENHANCEMENT AND COPIER DEVICES, ADAPTERS, AND POWER SUPPLIES); (b) IS USED FOR COMMERCIAL PURPOSES (INCLUDING RENTAL); (c) IS MODIFIED OR TAMPERED WITH; (d) IS DAMAGED BY NEGLIGENCE, ACCIDENT, UNREASONABLE USE, OR BY OTHER CAUSES UNRELATED TO DEFECTIVE MATERIALS OR WORKMANSHIP; OR (e) HAS HAD THE SERIAL NUMBER ALTERED, DEFACED OR REMOVED.

ANY APPLICABLE IMPLIED WARRANTIES, INCLUDING WARRANTIES OF MERCHANTABILITY AND FITNESS FOR A PARTICULAR PURPOSE, ARE HEREBY LIMITED IN DURATION TO THE WARRANTY PERIODS DESCRIBED ABOVE (12 MONTHS OR 3 MONTHS, AS APPLICABLE). IN NO EVENT SHALL NINTENDO BE LIABLE FOR CONSEQUENTIAL OR INCIDENTAL DAMAGES RESULTING FROM THE BREACH OF ANY IMPLIED OR EXPRESS WARRANTIES. SOME STATES DO NOT ALLOW LIMITATIONS ON HOW LONG AN IMPLIED WARRANTY LASTS OR EXCLUSION OF CONSEQUENTIAL OR INCIDENTAL DAMAGES, SO THE ABOVE LIMITATIONS MAY NOT APPLY TO YOU.

This warranty gives you specific legal rights, and you may also have other rights which vary from state to state. Nintendo's address is as set forth on the back cover of this booklet.

This warranty is only valid in the United States.

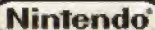

Nintendo of America Inc.

P.O. Box 957, Redmond, WA 98073-0957 U.S.A.

## N64 Expansion Pak<sup>TM</sup> Instruction Booklet

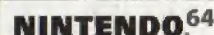

Thank you for purchasing the N64 Memory Expansion Pak Accessory for the Nintendo<sup>®</sup> 64 system. Before using the N64 Expansion Pak, first read this instruction booklet. If, after reading the instructions and precautions, you have questions on using the Expansion Pak or the N64<sup>®</sup> system, please call the Consumer Assistance Hotline at the telephone number listed below.

**NEED HELP WITH INSTALLATION,  
MAINTENANCE OR SERVICE?**



**Nintendo<sup>®</sup>**  
**AUTHORIZED REPAIR CENTERS<sup>SM</sup>**  
**1-800-255-3700**

MON. - SAT., 6:00 a.m. to 9:00 p.m.; SUN., 6:00 a.m. to 7:00 p.m., Pacific Time  
(Times subject to change)

You can visit our web-site at [www.nintendo.com](http://www.nintendo.com) for additional setup information, product news and game information.

*This official seal is your assurance that Nintendo has reviewed this product and that it has met our standards for excellence in workmanship, reliability and entertainment value. Always look for this seal when buying games and accessories to ensure complete compatibility with your Nintendo product.*



All Nintendo products are licensed by sale for use only with other authorized products bearing the Official Nintendo Seal of Quality<sup>®</sup>.

## ▲WARNING

PLEASE CAREFULLY READ THE CONSUMER INFORMATION AND PRECAUTIONS BOOKLET INCLUDED WITH THE NINTENDO 64 SYSTEM OR GAME PAKS BEFORE USING THE N64 EXPANSION PAK. THIS BOOKLET CONTAINS IMPORTANT SAFETY INFORMATION.

## N64 EXPANSION PAK

The N64 Expansion Pak is a special cartridge that contains 4 Megabytes (MB) of memory. When inserted into the Memory Expansion slot on the top of the N64, memory is added directly to the N64's existing 4 MB of memory, bringing the total up to 8 MB of main memory.

Only N64 Game Paks displaying the N64 Expansion Pak icon will take advantage of the additional memory features of the N64 Expansion Pak. Look for this icon on specially designed games.



Designed For N64  
Expansion Pak™



N64 Expansion Pak



Jumper Pak  
Ejector Tool

## ▲WARNING

HOT SURFACE - DO NOT TOUCH!

THE EXPANSION PAK WILL BECOME HOT WHILE THE CONTROL DECK IS ON. DO NOT TOUCH ANY PART OF THE EXPANSION PAK WHEN THE CONTROL DECK IS OPERATING. WAIT ONE HOUR AFTER TURNING THE CONTROL DECK OFF BEFORE TOUCHING OR REMOVING THE EXPANSION PAK. DO NOT ATTACH ANY LABEL OR STICKER TO THE EXPANSION PAK WHICH COULD BLOCK THE COOLING VENTS.

## INSTALLING THE EXPANSION PAK

1. Make sure that the power switch of the Nintendo 64 Control Deck is in the OFF position and that the power cord is unplugged from the wall outlet. (See Illustration 1.)

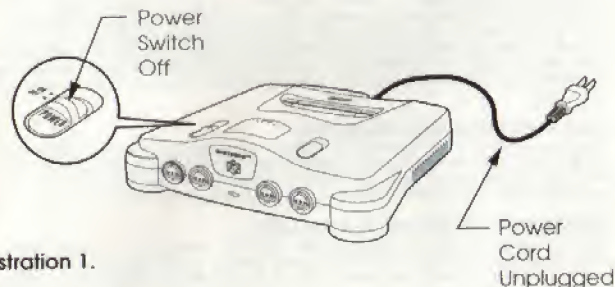

Illustration 1.

2. Remove the Memory Expansion Cover located on the top of the Nintendo 64 Control Deck and remove the red label. (See Illustration 2.)

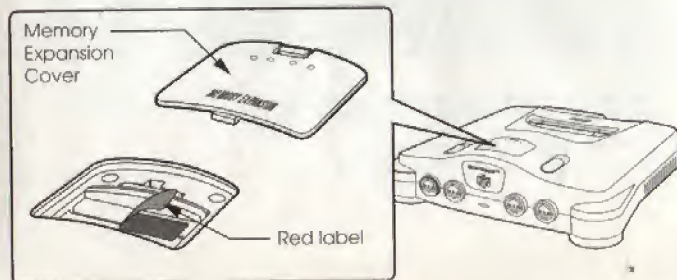

Illustration 2.



3. Insert the Jumper Pak Ejector Tool into the back of the Jumper Pak and push downward, ejecting the Jumper Pak out of the connector. (See Illustration 3.)



Illustration 3.

**CAUTION**

ALWAYS USE THE JUMPER PAK EJECTOR TOOL WHEN REMOVING THE JUMPER PAK OR EXPANSION PAK FROM THE N64 CONTROL DECK. THE USE OF ANY OTHER TOOL OR YOUR FINGERS MAY DAMAGE THE JUMPER PAK, EXPANSION PAK OR CONTROL DECK.

4. Insert the Expansion Pak into the Memory Expansion Connector, making sure that it is not loaded backwards. The text on the Expansion Pak should face towards the front of Control Deck. (See Illustration 4.)

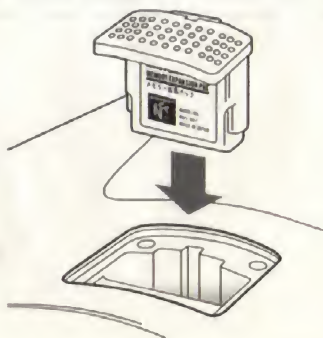

Illustration 4.

**IMPORTANT: ONCE THE EXPANSION PAK IS INSTALLED, IT IS NORMALLY NOT NECESSARY TO REMOVE IT FROM THE CONTROL DECK.**

The N64 Expansion Pak is designed to work with all Nintendo 64 Game Paks, even those which do not use the memory expansion features.

5. Replace the Memory Expansion Cover on the Control Deck. (See Illustration 5.)

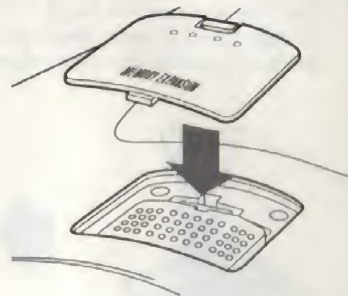

Illustration 5.

**CAUTION**

TO PREVENT DUST, DIRT OR OTHER FOREIGN MATERIAL FROM FALLING INTO THE EXPANSION PAK COMPARTMENT, BE SURE TO REPLACE THE MEMORY EXPANSION COVER AFTER INSTALLING THE EXPANSION PAK.

*If you would like to order a Jumper Pak Ejector Tool, Memory Expansion Cover or other Nintendo parts, please call the Consumer Assistance Hotline at 1-800-255-3700.*